

W WatchGuard® Ultra 24 Hour Plan



This plan provides expert service, preventive maintenance, and parts coverage for residential oil heat systems.

- 24-Hour Emergency Service with telephone support by our staff of expert Westmore Fuel Technicians. All our service vehicles are equipped with GPS and Automated Wireless Systems, so we can quickly locate the closest service vehicle to dispatch in an emergency.
- Annual Preventive Maintenance Visit (See next column)
- Coverage of all parts & labor marked with blue dots ● under "Parts & Labor Coverage" on next column

Covers Over \$3000 In Parts!

W Gold Plus® 24 Hour Plan



This comprehensive plan is simply the best service plan available in this area. It provides worry free 24 hour coverage of all major components of your heating system, including many expensive, hard to replace parts.

- 24-Hour Emergency Service with telephone support by our staff of expert Westmore Fuel Technicians. All our service vehicles are equipped with GPS and Automated Wireless Systems, so we can quickly locate the closest service vehicle to dispatch in an emergency.
- Annual Preventive Maintenance Visit (See next column)
- Extended parts & labor coverage (All parts & labor marked with both Red ● & Blue dots ● under "Parts & Labor Coverage" on next column)

Covers Over \$5000 In Parts!

Parts & Labor Coverage (for repair or replacement)

● Covered By WatchGuard and Gold Plus ● Covered only on Gold Plus

- | | |
|-----------------------------------------|------------------------------------------|
| 1 Air filters (1 change) ● | 43 Nozzle Adapter ● |
| 2 Air scoops ● | 44 Nozzle Line (Internal) ● |
| 3 Aquastats ● | 45 Nozzle line (External) ● |
| 4 Automatic Water feeders ● | 46 Oil filter cartridge (1 change) ● |
| 5 Back flow preventor ● | 47 Oil filter assembly ● |
| 6 Baffles ● | 48 Oil tank duplex fitting (Not shown) ● |
| 7 Base boards & radiation units ● | 49 Oil tank fill cap (Not shown) ● |
| 8 Belts ● | 50 Oil tank gauge (Not shown) ● |
| 9 Blast tubes ● | 51 Oil tank Vent alarm (Not shown) ● |
| 10 Blower Housing ● | 52 Oil tank vent pipe (Not shown) ● |
| 11 Blower motor pulleys ● | 53 Porcelain Insulators ● |
| 12 Blower motors ● (Max 1/3 HP Heat) | 54 Pressure relief valves ● |
| 13 Burner fans ● | 55 Pump gaskets ● |
| 14 Burner motors ● | 56 Pump strainers ● |
| 15 Cad cell relay controls ● | 57 Purge valves ● |
| 16 Cadmium cells ● | 58 Radiator valves (not shown) ● |
| 17 Circulator Bearing assy. & gaskets ● | 59 Re-set button ● |
| 18 Circulator coupling ● | 60 Smoke pipe ● |
| 19 Circulator motor (Max. 1/8 HP) ● | 61 Stack relays ● |
| 20 Circulator relays ● | 62 Steam vents (not shown) ● |
| 22 Delayed oil valves ● | 63 Thermostats (standard) ● (clock) ● |
| 23 Draft regulators ● | 64 Toggle switches ● |
| 25 Electrodes ● | 65 Transformers (Ignition) ● |
| 26 End cones ● | 66 Tricrator (Temp. & Pressure gauge) ● |
| 27 Expansion tanks ● | 67 Triple aquastats ● |
| 28 Exposed oil lines ● | 68 Tripped circuit breakers & fuses ● |
| 29 Fan & limit controls ● | 69 Valves (Ball, Gate) ● |
| 30 Flow Check Valve ● | 71 Water Drain Valves ● |
| 31 Fire valves ● | 73 Zone valves ● |
| 32 Flow restrictions (not shown) ● | |
| 33 Fuel Pump coupling ● | ● Not covered: for reference only |
| 34 Fuel pumps ● | 21 Combustion chambers ● |
| 35 Heat exchanger diagnosis ● | 24 Electrical wiring on furnace ● |
| 36 High vents ● | 37 Humidifiers ● |
| 38 Ignition wires ● | 39 Indirect hot water heaters ● |
| 40 Low voltage transformers ● | 41 Low water cut offs ● |
| 42 Nozzle ● | 70 Water coil ● |
| | 72 Zone dampers ● |

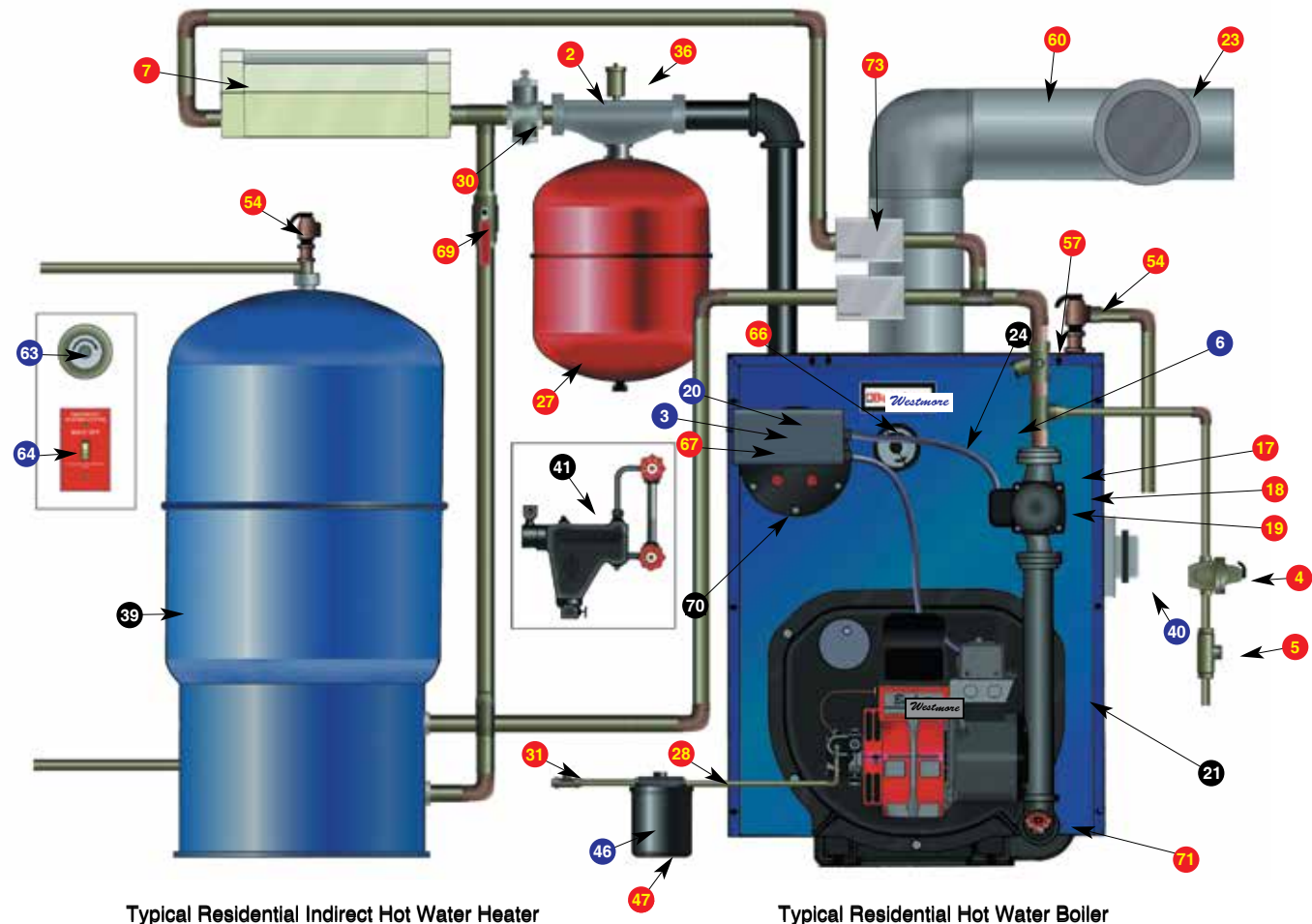

Typical Residential Indirect Hot Water Heater

Typical Residential Hot Water Boiler

Terms & conditions: A detailed description of all terms and conditions applicable to Westmore service plans is available upon request.

Annual Preventive Maintenance Visit

This comprehensive annual tune-up (Included with ALL Westmore Service Plans) will insure that your system is always running safely, reliably, and at its peak efficiency.

This visit includes...

- System safety inspection
- Vacuum cleaning and inspection of heat exchanger, combustion chamber, and exhaust system
- Nozzle, strainer, oil filter, & air filter inspection and change
- Motor lubrication
- Ignition & control calibration
- Combustion efficiency analysis which includes: draft analysis, flue gas analysis, stack temp/heat loss analysis, and efficiency report

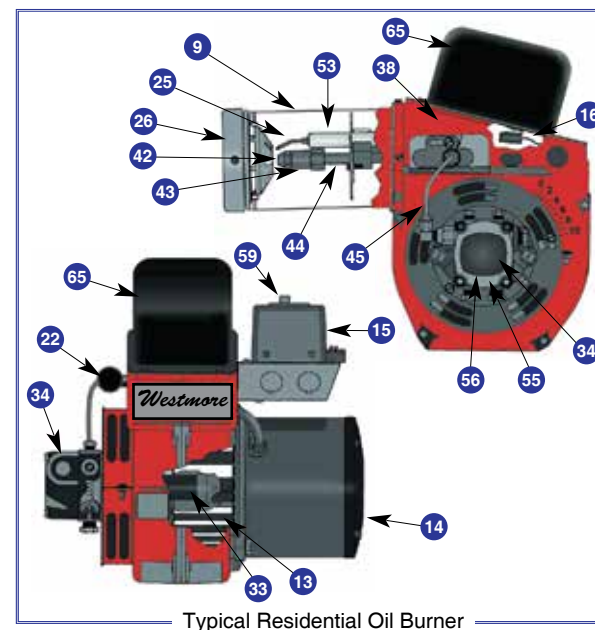

Typical Residential Oil Burner

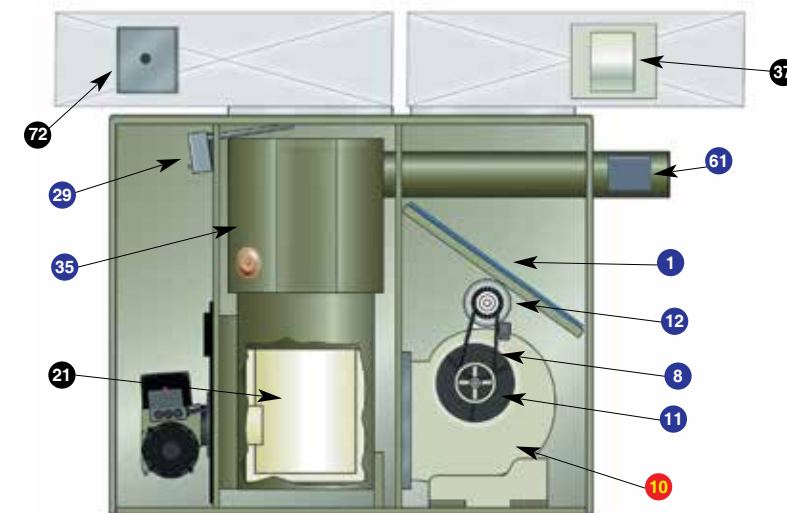

Typical Residential Warm Air Furnace

Quality Heating Equipment

Westmore Fuel only installs quality, name brand heating and hot water equipment. Our highly trained professionals will provide you with an accurate cost of upgrading your heating system. To help you conserve energy and protect your energy dollars, we'll also perform an in-home heating audit. Our new Fuel Savings Analysis Calculator (FSA), is a tool especially designed to show you how much energy and money you can save with new equipment. Westmore will perform a heat/loss evaluation and ask you plenty of questions, to insure we provide you with the right system for your energy needs. That's our promise!

With Hybrid Energy Recovery, System 2000 produces your home's heat plus almost endless hot water! It runs so efficiently and quietly. Its heavily insulated storage tank provides a ready supply of hot water. With System 2000's Hybrid Energy Recovery cycle, no heat energy is left wasted in the boiler. In addition, System 2000 can be installed *with or without* a chimney.



Buderus

Buderus has been the choice for high-end heating for decades. Representing European cutting-edge technology, Buderus has combined a compact, high efficiency boiler with an indirect hot water heater that makes an unbeatable combination. In the vertically stacked configuration, the system takes up a minimal amount of floor space, yet provides fast, reliable heat and a near-limitless supply of domestic hot water.



RIELLO



High Efficiency Burners

Thermo Pride

Thermo Pride Warm air furnaces provide quality, efficiency, and reliability that has made them a legendary name in oil fired furnaces. Westmore installs complete ducted systems including air conditioning. These furnaces are also available with humidifiers, and electronic air purification systems.



Bock

Bock oil fired hot water heaters produce more hot water than just about any other type of heater. Converting from gas or electric can save you hundreds each year!



Phase III

Phase III indirect hot water heaters provide a near limitless supply of hot water for just pennies a day. These units attach to an existing boiler and require almost no maintenance!



About our service staff...

All of the service staff members at Westmore Fuel take pride in their craftsmanship and ability to get the job done right the first time!

Our technicians are all trained at state approved heating schools, licensed by the state and are fully insured.

Westmore technicians are also employed directly by Westmore Fuel (We do not use sub-contractors). They will arrive at your home neatly

dressed, clean, and in a marked Westmore Fuel service vehicle.

Our technicians have the highest respect for your personal property, and can be TRUSTED to act properly and courteously

when in your home. This is something Westmore Fuel takes very seriously.

As always, we welcome your questions and suggestions so we can continue to improve our services, and we encourage you to write or call us any time you have a question concerning your Heating needs.



How do I take advantage of one of these comprehensive service plans? Just call our offices any time and ask for a service representative. You may also send in the price card included with this pamphlet.



westmorefuel.com

86 North Water St.

Greenwich, CT 06830

(203) 531-6800

(914) 939-3400

Fax (203) 531-5783

E-mail: customer@westmorefuel.com

www.westmorefuel.com

CT HOD #44 S-License #308868



Residential Service Plans



*A Company Built
Around Its Customers*